

FORM NO 1.

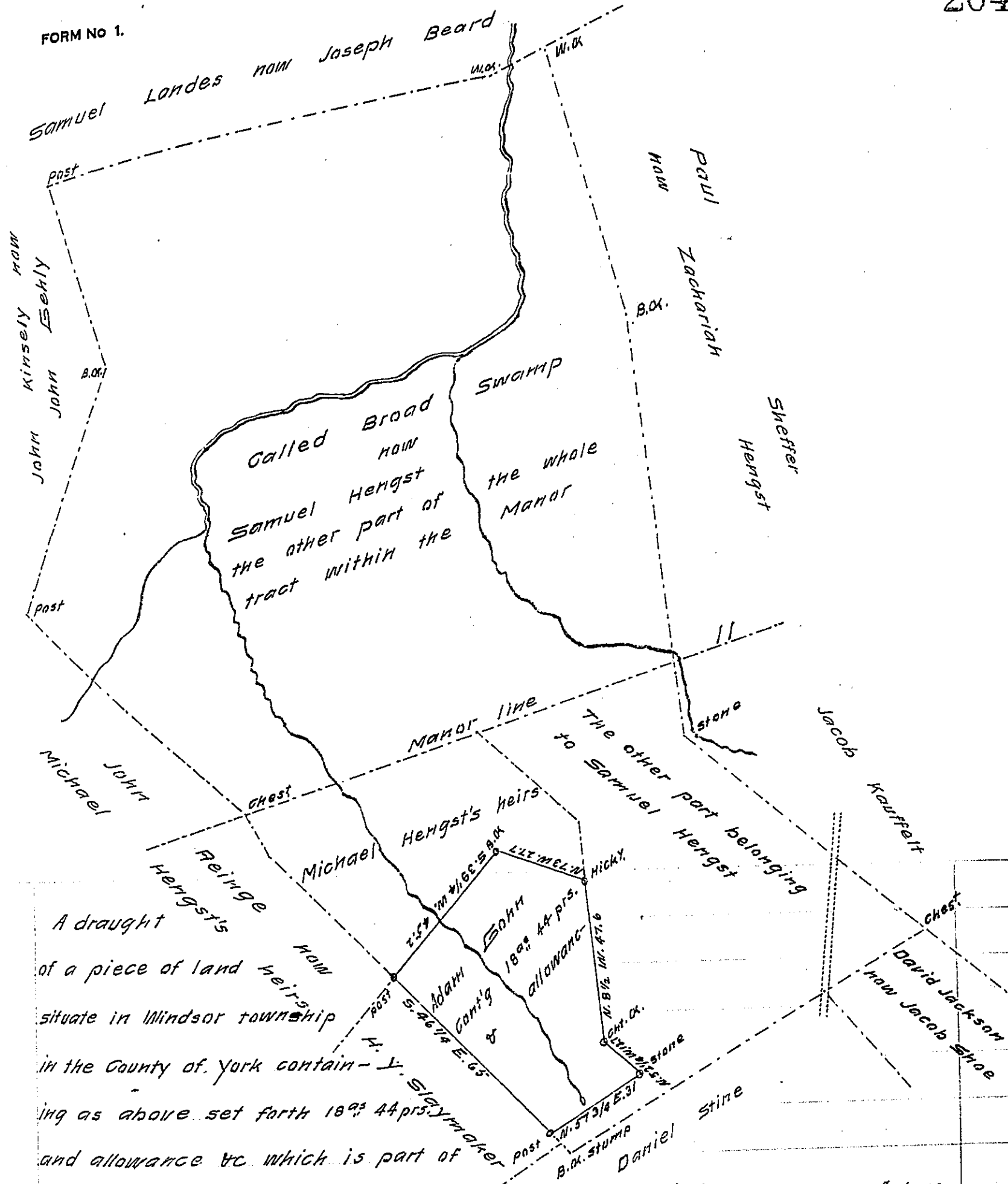

A draught of a piece of land situate in Windsor township in the County of York containing as above set forth 189 44 prs. and allowance &c which is part of 25 1/4 ac & allowances which was originally surveyed in pursuance of two warrants. One for 50 ac dated 1st June 1762 the other for 100 ac dated the 5th day of July 1762 granted to Adam Sohm, and surveyed by Wm Mathews D.S. on the 13th day of 6th mo. 1766 &c. Now resurveyed and divided said larger tract &c. and now on the 20th day of June A.D. 1836 being requested to make return of the above for Henry Slaymaker the present owner &c.

John Taylor Esqr Surveyor General, Per John Becker D.S.

IN TESTIMONY that the above is a copy of the original remaining on file in the Department of Internal Affairs of Pennsylvania, made conformably to an Act of Assembly approved the 16th day of February, 1833, I have hereunto set my Hand and caused the Seal of said Department to be affixed at Harrisburg, this Seventh day of April 1908

Henry Fowler
Secretary of Internal Affairs.